



# Electronic parallel ignitor for HID lamp circuits

## SI 52

HID ignitors for parallel systems

### Product data

General Information		T-Ambient (Min)	
Application Code	52		-20 °C
Operating and Electrical		T-Case Maximum (Max)	
Input Voltage	220 to 240 V		80 °C
Input Frequency	50 to 60 Hz		
Igniton Type	Parallel	Mechanical and Housing	
Ignition Voltage (Max)	0.75 kV	Housing	Akulon S223
Ignition Voltage (Min)	0.58 kV	Approval and Application	
Response Voltage	190 V	Approval Marks	CE marking
Mains Voltage Performance (AC)	-8%+6%	Product Data	
Mains Voltage Safety (AC)	-10%+10%	Full product code	871016303343300
Power Losses (Nom)	0.5 W	Order product name	SI 52
Wiring		EAN/UPC - Product	8710163148595
Ballast Contact Wire Cross Section	0.50-2.50 mm <sup>2</sup>	Order code	913710010814
Connector Type	Screw	Numerator - Quantity Per Pack	1
Temperature		Numerator - Packs per outer box	48
T-Ambient (Max)	75 °C	Material Nr. (12NC)	913710010814
		Net Weight (Piece)	0.049 kg

## Electronic parallel ignitor for HID lamp circuits

### Dimensional drawing

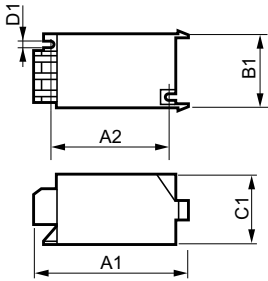

Product	C1	A1	A2	B1	D1
SI 52	38.5 mm	85.5 mm	65.0 mm	41.5 mm	4.3 mm

SI 52

